

SUPREME CORDED CURTAIN TRACK

FITTING GUIDE

What you will need



Child Safety

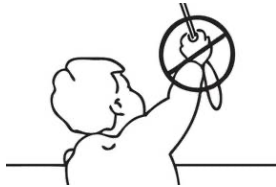

Young children can be strangled by loops in pull cords that operate the product. To avoid strangulation and entanglement keep cords out of the reach of young children.

Cords may become wrapped around a child's neck. Move beds, cots and furniture away from window covering cords. Do not tie cords together. Make sure cords do not twist and create a loop.

Safety Devices

This product has been supplied with a Safety Cord Retainer to make this product safe in line with the child safety regulations outlined in BS EN13120.

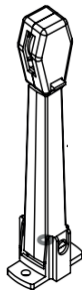

Please note it is a requirement in accordance with BS EN 13120 to install the Tensioner and the installer is liable to ensure child safety.

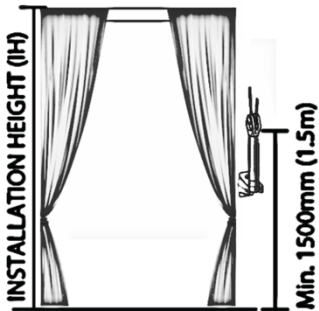

WARNING

Children can strangle if this safety device is not installed. Always use this device to keep cords out of reach of children.

	Track(cm)	150	200	250	300	350	400	500
a	Wall Plate	4	5	6	8	8	10	12
b	Brackets	4	5	6	8	8	10	12
c	Levers	4	5	6	8	8	10	12
d	Pulleys	2	2	2	2	2	2	2
e	Gliders	18	24	30	36	42	52	60
f	Track	1	1	2	2	2	2	2
g	Joiner	0	0	1	1	1	1	1
h	Tension Cord Pulley	1	1	2	2	2	2	2
i	Centre Pulley	0	0	1	1	1	1	1
j	Master Slide	2	2	2	2	2	2	2

Installation of Supreme Corded Curtain Track

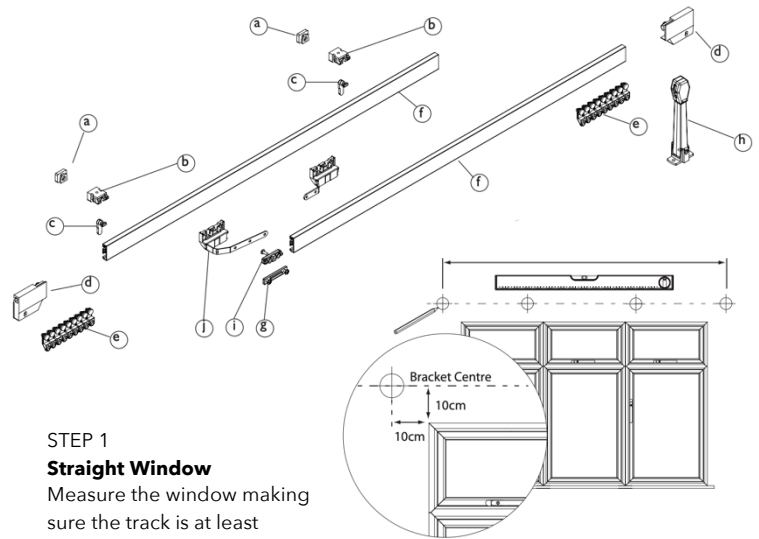

STEP 1

Straight Window

Measure the window making sure the track is at least 30cm longer, ensuring you have enough track to cover the window.

Mark a minimum of 10cm above each corner of your window, with a pencil draw a faint line from one mark to the other using a spirit level. Increase the line length a further 10cm either side and mark this position. The remaining brackets should be equally spaced along the total length.

Bay Window

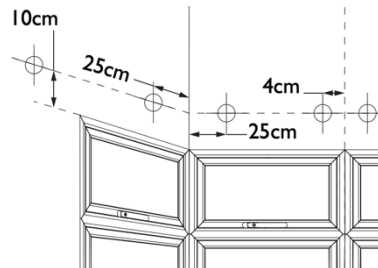

Mark a faint line 10cm above your window with a pencil using a spirit level. Mark the centre of the window. Then mark the centre bracket positions, 4cm either side of this central mark.

Mark the positions of the corner brackets 25cm from the corner of the bay. Mark

the position of the end brackets 4cm shorter than the required end position of the track. (see below for measuring your track) Space the remaining brackets positions evenly along the straight runs.

Ceiling fix.

This product can be fixed to a ceiling in either straight or bay windows. Screw directly through the top of the standard brackets.

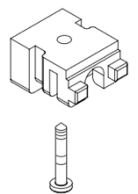

STEP 2

Fitting brackets

Drill the hole positions and fix the wall plate to the wall on the marked positions. Fit brackets onto the wall plates and insert levers into brackets, leaving the levers vertical (unlocked position).

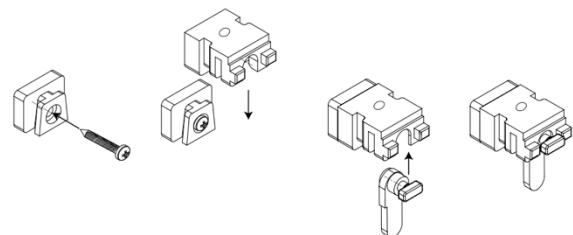

STEP 3

Measuring the track Straight Window

The track should extend approximately 15cm either side of your window. If your track is in two lengths then the track lengths should be equal, with the join in the centre. Mark the track lengths in preparation for cutting and offer up the track to the window to check the fit.

Bay Window

Starting from the centre of the window (previously marked) work your way outward. Measure the distance from the centre of the window to the bracket closest to the first bay corner (Pos. 1). Measuring from one end of the track, mark this distance on the track. Mark the midpoint of the bend 18cm further along the track.

Start bending the track around your knee ensuring you create a smooth gradual curve. The bend radius should be a minimum of 22.5cm Bend the Track slowly and carefully, offering the track up to the window regularly to ensure the bend is correct. Additional bends can be added by repeating the steps above.

Offer the rear channel of the track to brackets and lock into place by rotating lever through 90° to a horizontal position. Mark your track lengths 4cm after the last bracket in preparation for cutting.

Repeat for opposite side and remove the track from the brackets.

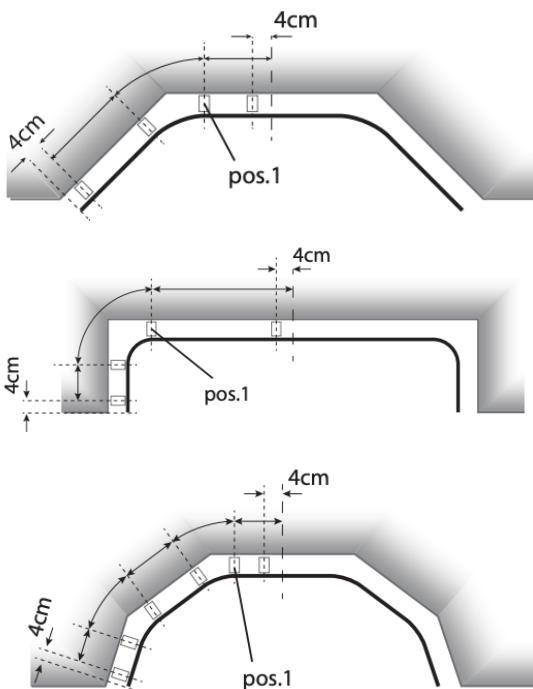

STEP 4

Cutting the Track

Mark the track to the correct length. 10 cm inward from the cut mark, mask the track to prevent the product becoming uncorded. Remove the end pulley and move the cords away from the track taking care not to twist the cords.

Mask the cut area to protect the track. Cut the track on the marked line using a sharp hacksaw.

Remove any sharp edges using a file. Replace the pulley taking care not to twist the cords.

NOTE: If joining two tracks, cut an equal amount from the ends of the track and not the centre meeting point to ensure a smooth even centre joint. If using a single section of track just replace the pulley housing.

STEP 5

Joining the track

Slide the joiner halfway into the top profile of one track. Tighten the screw. Slide the other track onto the joiner and butt the tracks up together and ensure both screws are tight.

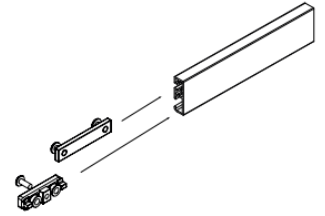

STEP 6

Adding Gliders

Remove end pulley. Slide the correct number of gliders onto the bottom channel of the track. You should use approximately 1 per 10cm run of track. Replace end pulley.

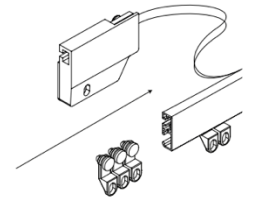

STEP 7

Fitting the Track

Starting at one end, locate the back of the track into the first fixing bracket allowing 5cm of track to project at the end. Lock the first bracket by rotating the lever through 90 degrees to a horizontal position. Fit the track to each bracket in turn then lock into position. Once all are fitted and securely tightened you should now be ready to hang your curtains.

If fitting into a bay, start at the centre and work outwards, 2 people may be required.

STEP 8

Centring the Master Slides

Pull outer cord until looped carrier is tight against gliders. Ease cord loop out of master carrier (this will reduce the length of the pull cord) and pull inner cord loop until knotted carrier is tight against gliders. Pull outer cord pull to reduce excess cord on looped master carrier and secure loop.

NOTE: If knotted master carrier reaches gliders first, pull out loop from looped master carrier and move carrier by hand until it reaches gliders. Pull outer cord to reduce excess loop on looped master carrier and secure.

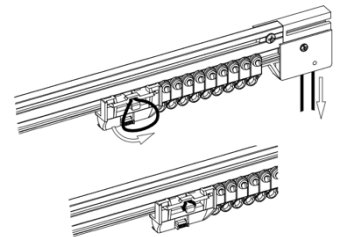

STEP 9

Installing the Cord Tension Pulley

Go to Master Slide with the knotted cord ends and pull down on the right-hand knot to reduce the cord loop. To prevent the risk of child strangulation the cord loop must be 1m maximum from the rail and the tension pulley must be fitted a minimum of 1500mm (1.5m) above the floor.

Using the two screws supplied, fix the tension pulley in the correct position, directly in line with the pull cord. Fully extend pulley housings and rotate 90° to lock. Press the cover release button on the tension pulley. Lift the cover and loop the cord around the pulley wheel. Close the cover and release the lock on cord tensioner by rotating 90°.

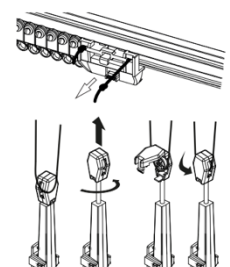

Take up the slack of the cord and tie a knot behind the Master Slide arm. The cord will now be fully tensioned. If there is insufficient tension in the cord, reduce the cord length by adjusting the knot behind the Master Slide arm.

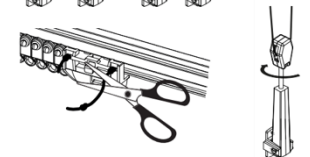

Cut the excess cord in front of the knot. If the cord becomes twisted, simply rotate the head of the pulley to untwist it. The track is now ready to accept curtains.